



PO Box 128 | 504 Highway 63 South | Freeburg, MO 65035 | 800-347-0438 | 573-469-4151 (fax)

Installation Guidelines for all aluminum Quaker products through jamb

Read these instructions completely before starting any installation. Failure to install and maintain our product according to these instructions may void any product warranty. Please visit our website at www.quakerwindows.com or call 1-800-347-0438 for additional information.

Tools required by installer:

Safety glasses		Utility knife	
Drill/Driver		Caulk gun	
Level		Tape measure	
Hammer		Putty Knife	

Materials required by installer:

Foam Backer Rod		Minimally Expanding Foam	
Shims (Waterproof)		Sealant	
Fasteners		Denatured Rubbing Alcohol	
			

⚠ WARNING

Tools

- Follow manufacturers instructions for safe operation of tools, and ladders/scaffolding. Always wear safety glasses. Failure to do so could result in injury, product or property damage.

Handling

- Do not store units outside, or in a hot environment. Doing so could result in product damage.
- Do not carry flat.** Doing so could result in product damage, injury, or property damage.
- Stack units as straight as possible to avoid bowing. **Do not lay flat!**

Glass

- If broken, glass can fragment causing injury. All Quaker products are available with safety glass. In many areas, local building codes require safety glass in certain locations and/or applications. Unless safety glass is ordered, Quaker windows are not provided with safety glass. Before ordering, consult your local building codes for more definitive information.

Fastening

- Metal fasteners and components could corrode when used with preservative-treated lumber. Use approved fasteners and components to fasten window or door. Failure to do so could cause a failure resulting in injury, product or property damage.
- Fastener must attach to a structural framing member with 1 1/2" minimum fastener embedment, or minimum 3 full threads with a minimum 5/16" head as products were tested with.
- Quaker does not supply anchorage/fastener calculations, and is not responsible for determining structural adequacy of the anchorage and fasteners used to install our products, or the openings into which they are installed.**
- Do not over drive screws or nails.** Doing so could result in product damage.

CAUTION**Installation**

- Always support window or door in opening until fully fastened. Failure to do so could result in the window or door falling out or causing injury, product, or property damage.
- Nailing flanges and drip caps (integral or applied) **do not** take the place of window flashing. All windows and doors must be properly flashed and sealed with material compatible sealant for protection against water and air infiltration around the entire perimeter. Failure to do so could result in product or property damage.
- **Do not** set window directly on sill plate. Place shims under the side jambs. Window or door must be properly shimmed. Failure to do so could affect operation and product performance and could result in product damage.
- Live or dead loads transferred into our product can affect functionality, damage frame joinery or cause glass failures. Dead loads such as upper levels, roof, etc. Should be constructed before window or door is installed.
- Loads shall be designed to withstand the most critical effects of load factors and load combinations as required by the building code. (Loads are including but not limited to Live, Dead, Collateral, Auxiliary, Thermally induced, Seismic, etc.)
- Maximum vertical deflection of the header under all Load combination should not exceed the Span/720 or 1/4" whichever is less.
- Windows and doors have small parts. Small parts if swallowed could pose a choking hazard to young children. Dispose of unused, loose, or easily removed small parts. Failure to do so could result in injury.
- **Do not** drill through or into window sill to install alarm wires.

Sealing

- Follow instructions of foam, sealant, and flashing manufacturers regarding safety, material application, compatibility, and periodic maintenance for continued weather resistance of their products. Failure to do so could result in product or property damage. **DO NOT** overfill between the frame and opening.
- Minimally expanding foam insulation must be compliant with AAMA 812-04.
- Quaker recommends 100% silicone (ASTM C920 compliant) neutral cure only sealant. Always clean all areas where sealant will be applied. Failure to do so could result in product or property damage.
- Flashing tape must meet ASTM-D779 performance requirements.
- Maintain a minimum of 1/4" between the window or door frame and exterior finish materials. Failure to do so could result in product or property damage.

Joining

- Do not join any window or door to any window or door not designed for joining. Joined windows and doors must be individually supported in the opening. Failure to do so could affect operation and product performance and could result in product or property damage.

Cleaning

- Acid solutions used for cleaning will damage glass, fasteners, hardware, and metal flashing. Protect these products and follow cleaning products manufacturers instructions. If acid contacts the window or door, wash all surfaces immediately with clean water.
- **Do not** use razor blades to clean glass surface. Glass damage could result.
- Clean glass using liquid glass cleaner.
- Clean frame, sash, panels, and insect screens using mild detergent and warm water with a soft cloth or brush.

IMPORTANT

- Buildings constructed prior to 1978 could contain lead paint which could be disturbed during window or door replacement. For more information on proper management of lead paint, go to: www.epa.gov/lead
- Care must be taken to properly recycle or dispose of old materials. Any recyclable materials should be separated from non-recyclable or hazardous materials. Please consult with local or state authorities regarding proper disposal of non-recyclable or hazardous materials.
- These are generic instructions intended to cover most common situations, which may not be appropriate for all installations due to building design, construction materials, or methods used and/or building or site conditions. Consult a contractor or architect for recommendations.
- Inspect all units for any damage or defects prior to installation. Contact the nearest Quaker distributor if there are any problems.

1

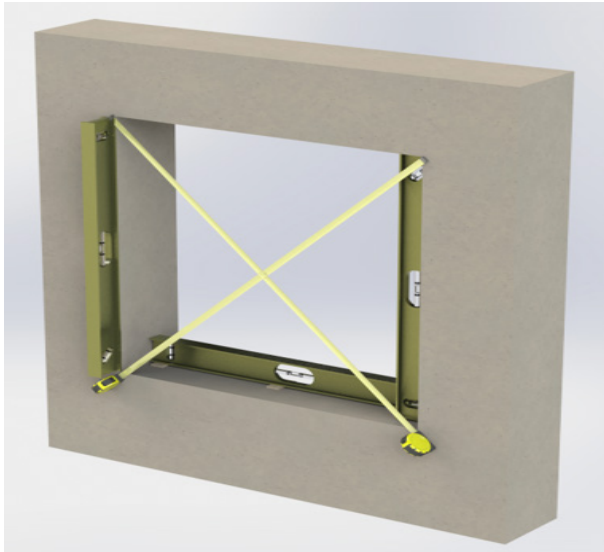

Measure and verify the size of the rough opening. The rough opening should be a minimum $\frac{1}{2}$ " (but not to exceed 1") wider and taller than the unit. The masonry opening should be sized $\frac{1}{2}$ " wider and $\frac{9}{16}$ " higher than the units exterior frame. Verify the rough opening is flat, plumb, level, and square. Take diagonal measurements to check for square. The sill beneath the unit must be level for proper unit operation.

2



Check the fit of the unit making sure the conditions are level, the installer can pre-apply the shims to the sill condition prior to installation of the window frame.

3



The glazing bead may require removal and reinstallation. Be careful to avoid damaging the glazing beads and finish. Slide a putty knife between the glazing bead and frame at the bottom corner and apply pressure as you rotate the putty knife away from the window frame.

4



Drill a pilot hole thru the side jamb 4" from each corner and 16" on center.

5

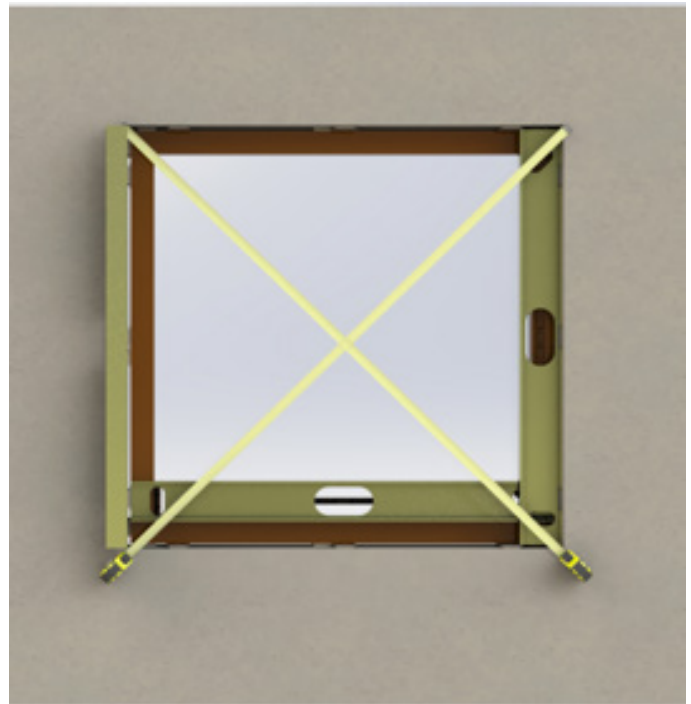
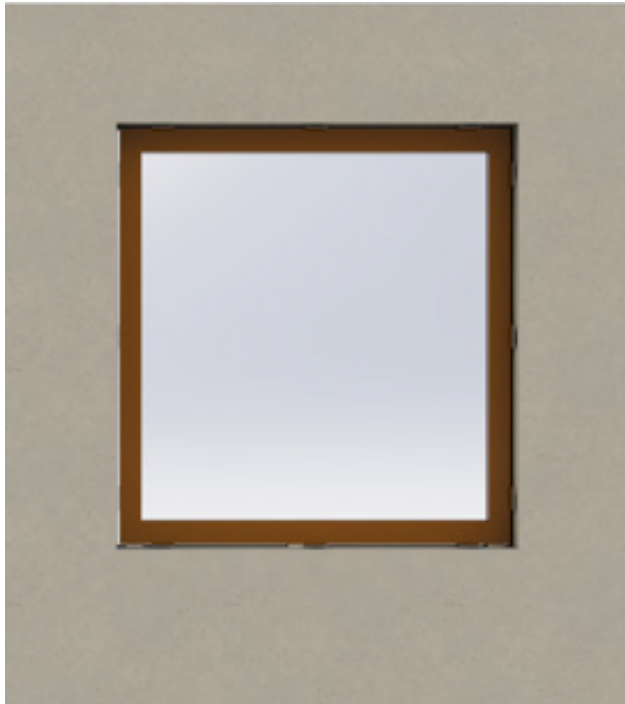

Set the window in place on top of the shims at the sill, and center in opening. Place a level on the window sill to verify that the sill is level. Adjust the shims as needed to ensure a level condition. Check the head, sill and jambs with a level again to make sure the window is setting plumb, level, and square within the opening. Measure across the diagonals to determine if the window is square.

6

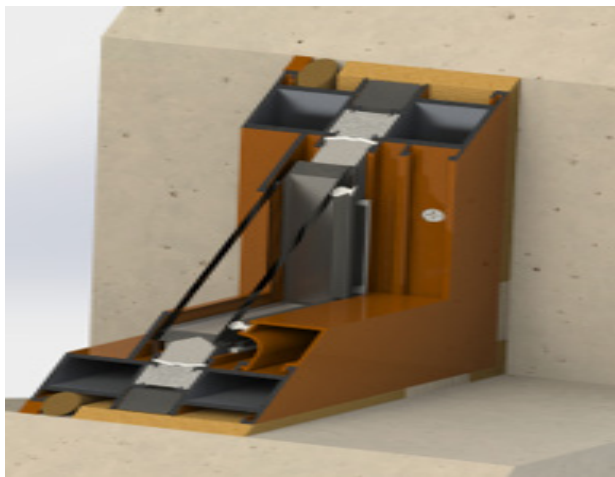

Install fasteners as required at the remaining anchor points per shop drawings and or anchorage calculations. Always follow the fastener/anchor manufacturer's guidelines for proper edge distance, load capacity and installation techniques. For casement windows, add blocking and anchors at the hinge locations. For sliding windows, add support blocking behind the jamb condition at the locking point. Check the installed product to ensure that it operates properly and that the reveal is equal between the sash and frame. Reinstall glazing beads using a shim or rubber mallet to lock them back in place.

7



If total frame replacement in brick or siding was performed maintain a minimum of $\frac{1}{4}$ " between the window frame, trim, siding, or masonry. Failure to do so could result in product or property damage. Apply backer rod (if needed) and a continuous bead of sealant between the window frame and exterior finish material on all four sides of unit. Make sure to clean all surfaces before applying 100% neutral cure silicone sealant (some surfaces may need to be primed so check with sealant supplier).

8

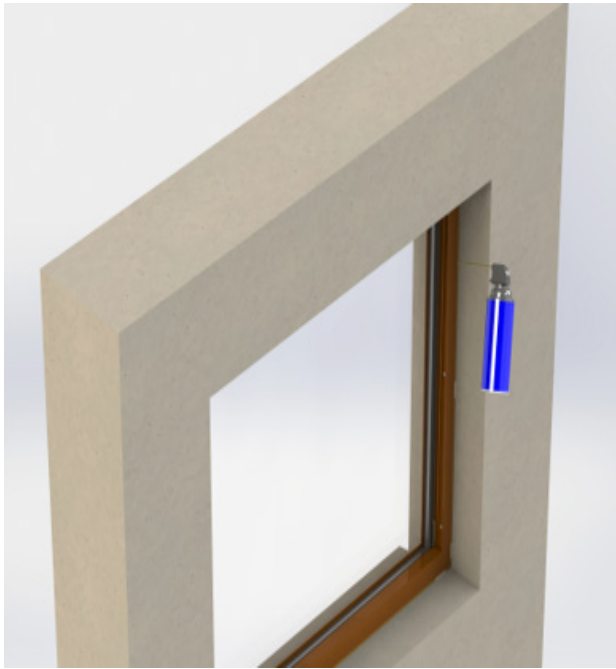

Insulate between the window frame and the rough opening using minimally expanding window and door spray foam or fiberglass insulation that is compliant with AAMA 812-04. Read and follow the manufacturers' recommendations for application and use.

9

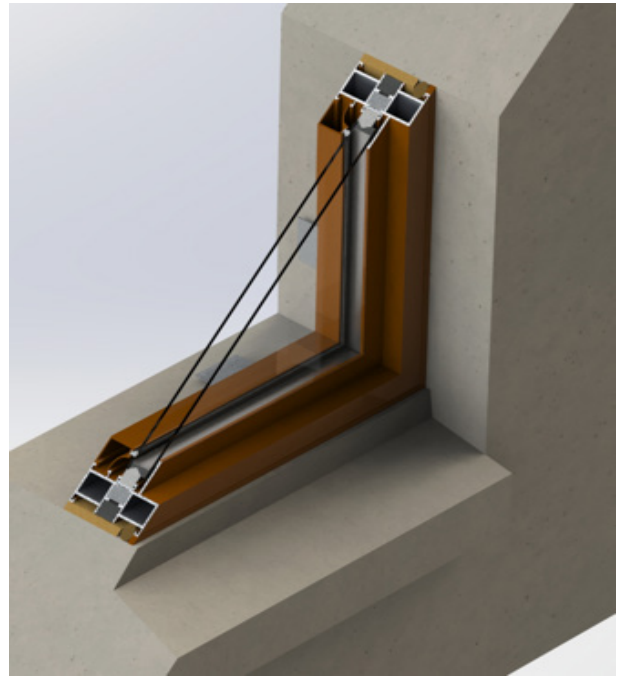

Operate window unit to ensure proper operation. Sash will not operate correctly if window is out of square, over-shimmed or over-insulated. Allow foam to fully cure before installing interior trim. Install interior finish trim.



Installation Guidelines

For All aluminum Quaker Products Through Jamb

If this set of instructions doesn't match your installation method or wall conditions please check our website listed below for other options, or call the office.

Scan here for a digital version of these guidelines in English



Scan here for a digital version of these guidelines in Spanish



Or go to: <http://quakerwindows.com/installation-instructions-videos/>

Or go to: <http://quakerwindows.com/installation-instructions-spanish/>

